

GEODETSKA IZMJERA

Zadatak

Odredi koordinate točkaka 8 i 9 i izračunaj površinu koju zatvaraju točke objekta (7, 8, 9 i 10).
Odredi koordinate točkaka 3 i 4.

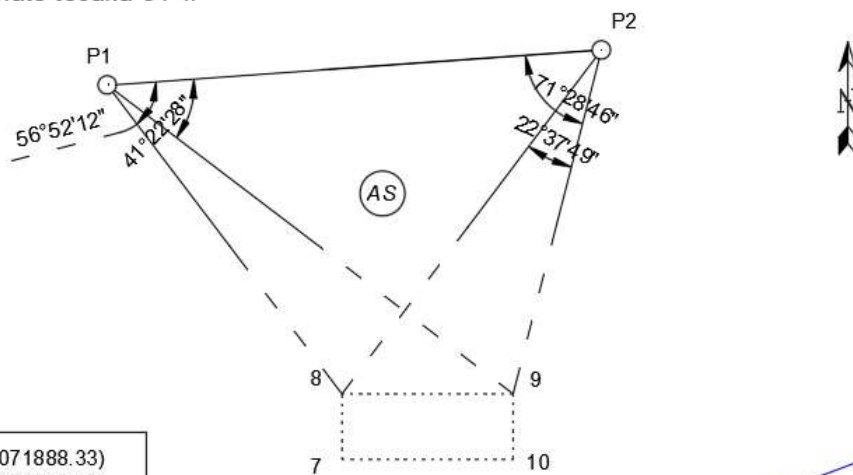

Mjereni kutovi

α	56-52-12
β	41-22-28
γ	71-28-46
δ	22-37-49

P1 (457938.14, 5071888.33)
P2 (458003.06, 5071892.92)

7 (457968.97, 5071839.16)
10 (457991.45, 5071839.16)

ST P1	Or P2	0-00-00	d_{hor}
	3	75-22-18	78.90
	4	48-34-58	98.46

